

4. Remove the filter clamps that secure the filter in the frame, by pulling these out of the sliding grooves.

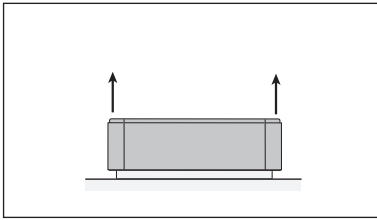

7. Lift the frame from the filter.

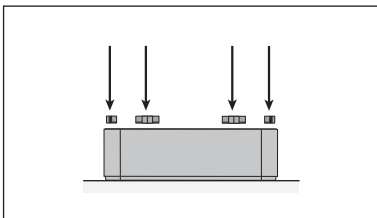

10. Make sure that the filter is inserted all the way into the frame. Insert the clamps into the sliding grooves inside the frame and push them down.

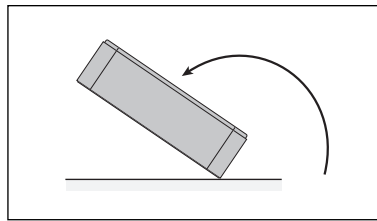

5. Turn the frame upside down.

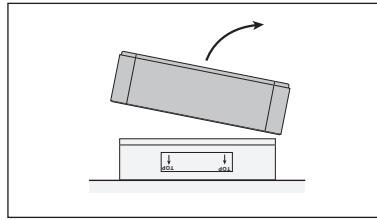

8. Dispose of the used filter.*

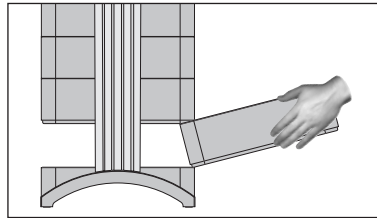

11. Put the frame back into the housing. For details on how to close the housing, please refer to the section.

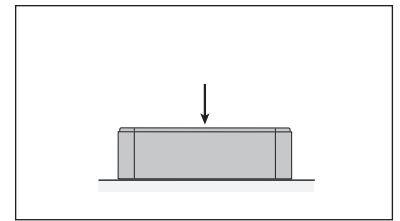

6. With the palm of the hand, press down on the filter element and loosen the frame.

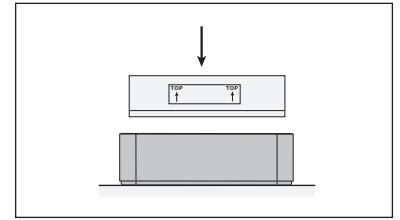

9. Turn the frame around and insert the new filter. Ensure that the arrows on the filter label point upward.

* If harmful substances are filtered, disposal of the used filters may be subject to local regulations or laws.

III. Resetting the new Filter Menu

The New Filter Menu allows you to reset the filter life counter for a newly replaced filter. As a result, the appropriate filter life LED on the control panel will be reset to green and the hour count in the Remaining Filter Life Menu will be reset to the full life span of the new filter.

Resetting the filter life counter will also make the “Replace Filter” warning disappear from the main display window.

- To reach the New Filter Menu from the main display window, press the **Menu** key seven times.
- Press and hold the **Enter** key until the flashing filter appears (PreFilter or PreMax).
- Press the **Enter** key to confirm that the Pre-filter has been replaced. To safeguard against inadvertently resetting the life of the wrong filter, the selection needs to be reconfirmed. The filter life LED for the appropriate filter is now flashing red. Note: If the wrong filter has been selected, or if you wish to exit the enter mode, simply press the **Menu** key. This will leave the filter life controller unaffected.
- To confirm the filter change and exit the New Filter Menu, press the **Enter** key.
- To check the life span of the newly installed filter after having reset the controller, simply go to the Remaining Filter Life Menu and select the appropriate filter number. (Please note that the reset remaining filter life may vary from model to model.)

